

GATE LOCATION	LENGTH	QTY W/O NOTCH	QTY W/ NOTCH
FRONT CENTER	40 1/8"	1	
CENTER	42 7/8"	2	
REAR CENTER	42 7/8"		2
RIGHT HAND	25 1/4"	1	
RIGHT HAND REAR	24 1/4"	1	
LEFT HAND	37 1/4"	1	2
LEFT HAND REAR	36 1/4"	1	
PANEL OVER DOOR	29 5/8"	1	

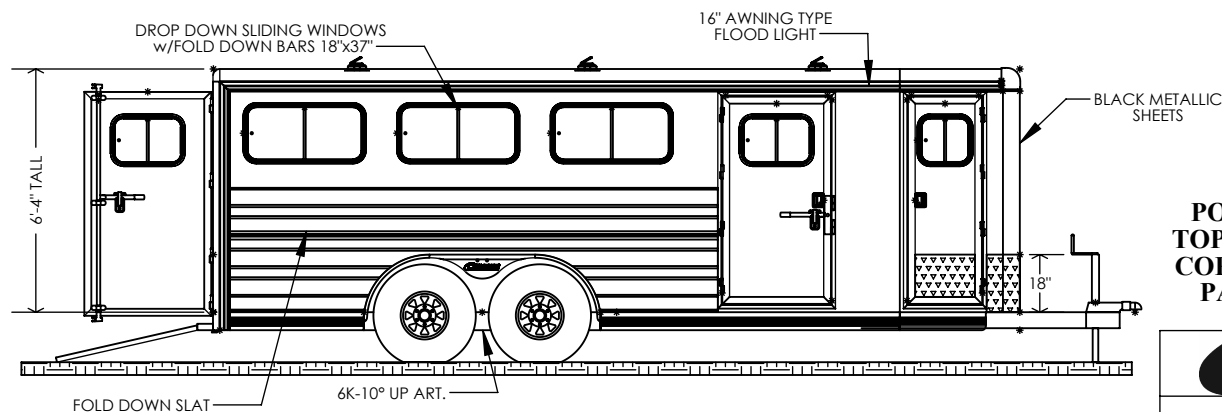
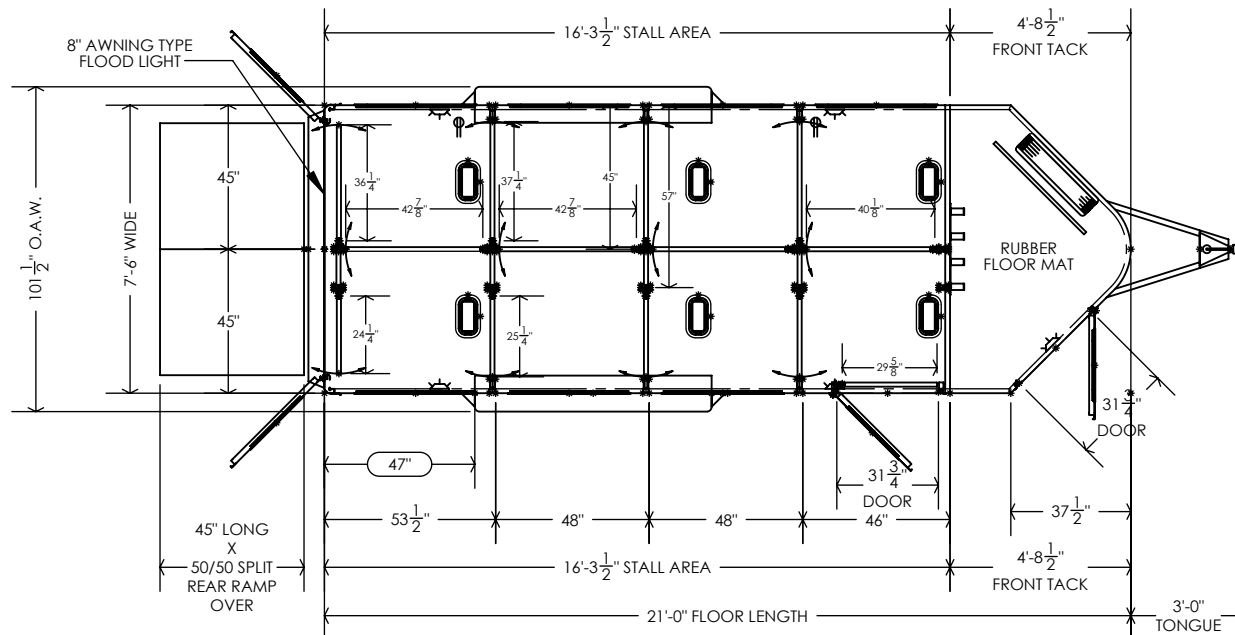
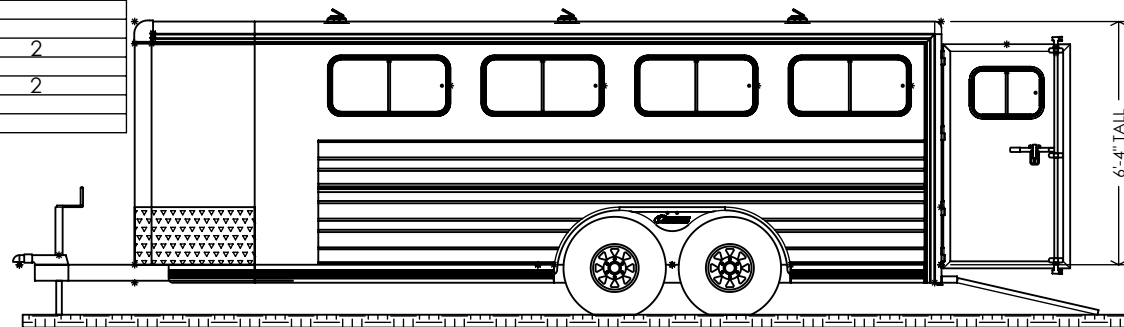

DIMENSIONED W/
TRACK INSTALLED

SLAT STACK CODE:
1429-FDS-19

BOLD: FOLD DOWN SLAT
UNDERLINED: UPSIDE DOWN

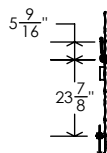

X/Z VALUE: 0.794118

PROPRIETARY AND CONFIDENTIAL

THE INFORMATION CONTAINED IN THIS
DRAWING IS THE SOLE PROPERTY OF
CIMARRON TRAILERS. ANY
REPRODUCTION IN PART OR AS A WHOLE
WITHOUT THE WRITTEN PERMISSION OF
CIMARRON TRAILERS IS PROHIBITED.

ALUMINUM 21'-0" X 7'-6" SHOWSTAR STOCK MODEL BUMPER HITCH TRAILER

**POLISHED SIDE SLAT,
TOP RAIL, REAR FRAME,
CORNER CAPS, ROCKER
PANELS, & FENDERS**

Cimarron
TRAILERS®

CHICKASHA, OKLAHOMA 73023

DEALER: JH SANDERS

WORK ORDER NO.: CTM11924

CUSTOMER: INVENTORY

DATE: 6/25/2018 **DRAWN BY:** BWS