

TrailWest®



7'0" wide
living quarters

TrailWest®

EXCEED YOUR EXPECTATIONS, NOT YOUR BUDGET
WWW.TRAILSWESTTRAILERS.COM

weekenderpackages

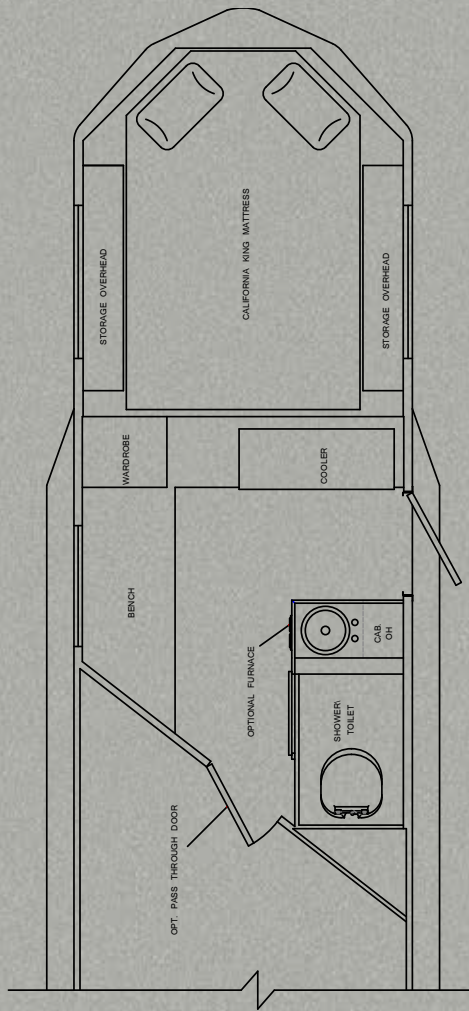

5 X 10

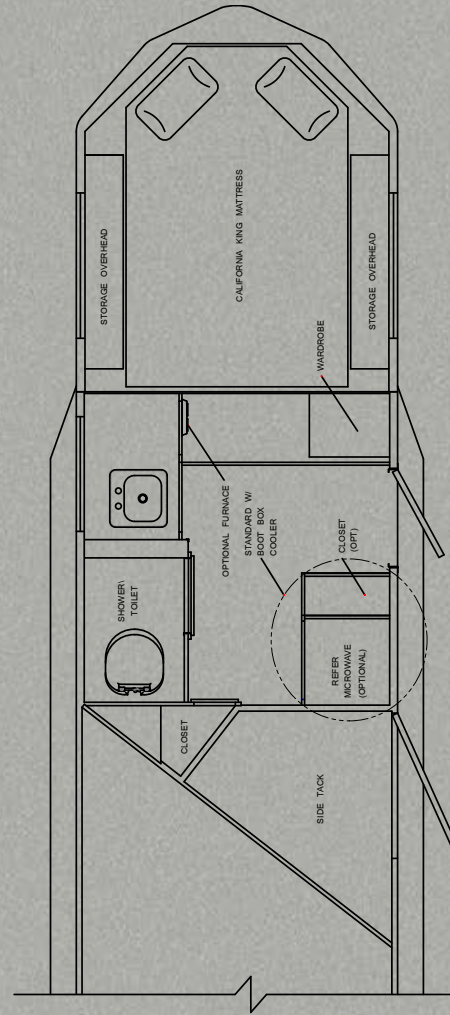

7 X 7 SIDE TACK

Standard Interior



7 x 7 shown w/optional microwave and refrigerator



7 x 7 Sink Area



7 x 7 Gooseneck Bed Area

7'0" wide floorplans

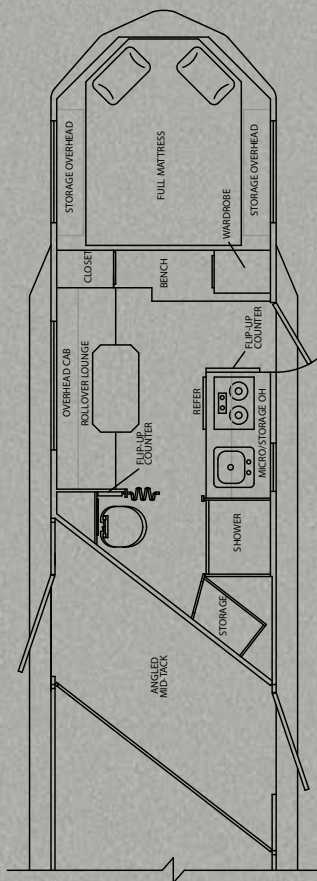

8 X 13 AMT

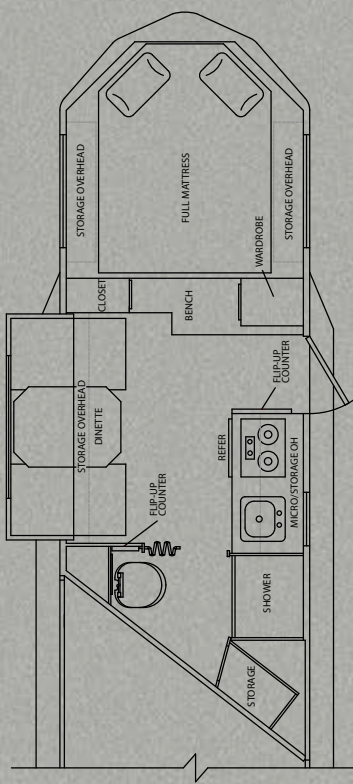

8 X 13 SLIDE-OUT

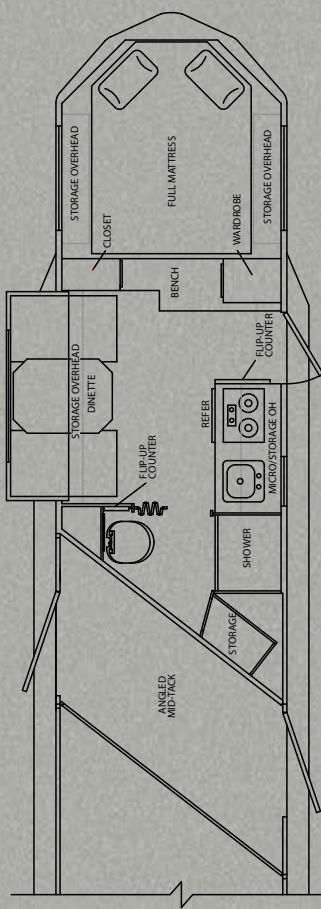

8 X 13 SLIDE-OUT AMT

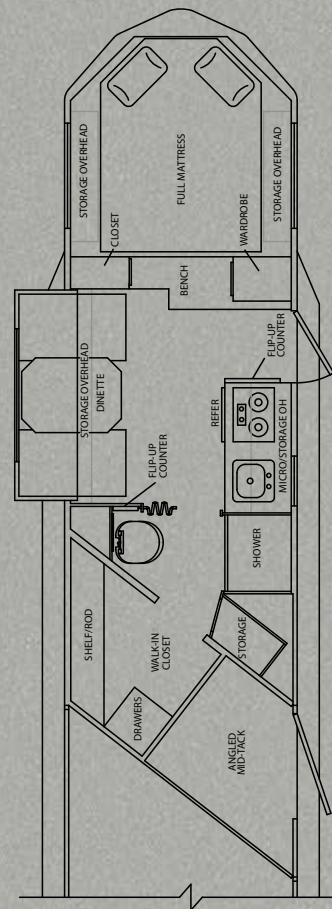

8 X 13 SLIDE-OUT AMT W/CLOSET

Standard Interiors



10 x 10 Bathroom Sink / Vanity



8 x 13 Galley

7'0" wide floorplans

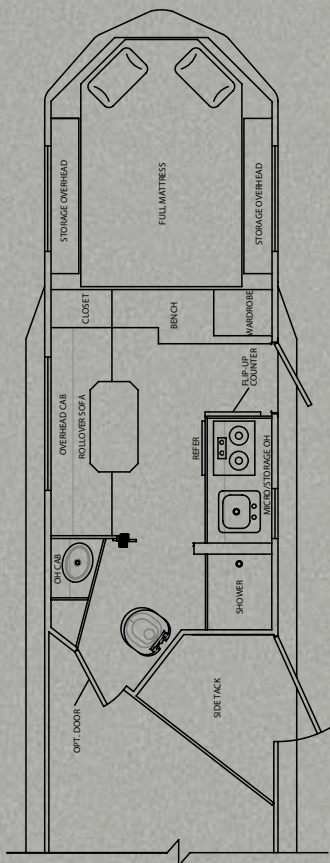

10 X 10 SIDE TACK

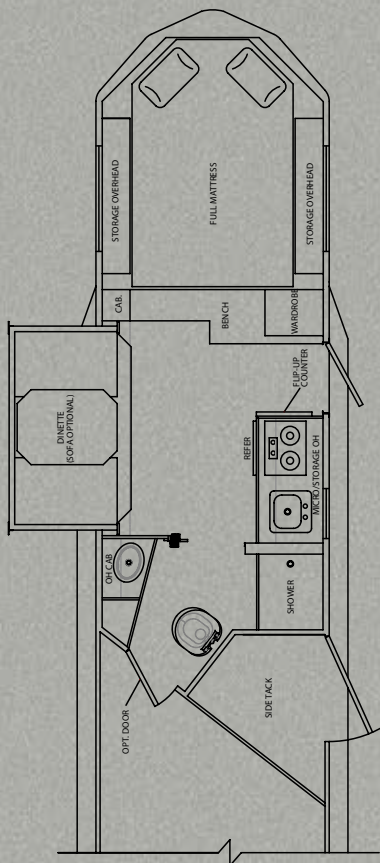

10 X 10 SIDE TACK
SLIDE OUT

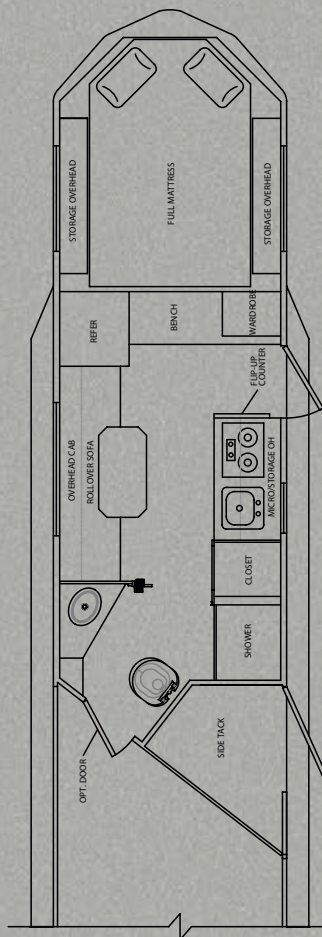

12 X 12 SIDE TACK

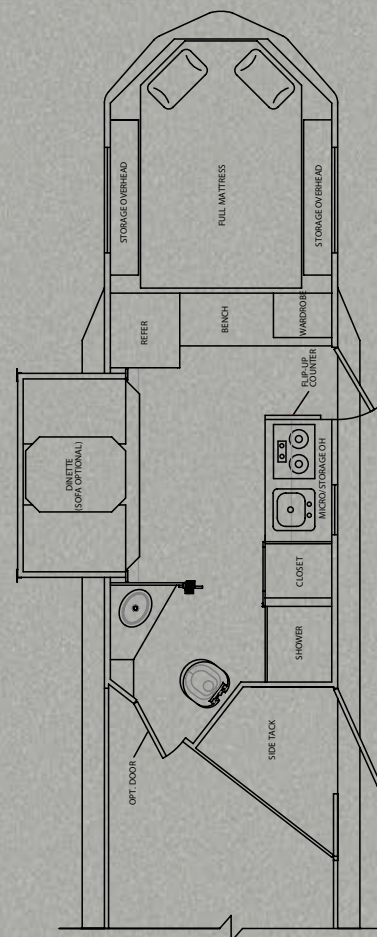

12 X 12 SIDE TACK
SLIDE OUT

Standard Interiors



10 x 10 (non-slide-out)



12 x 12 Galley

7'0" wide floorplans

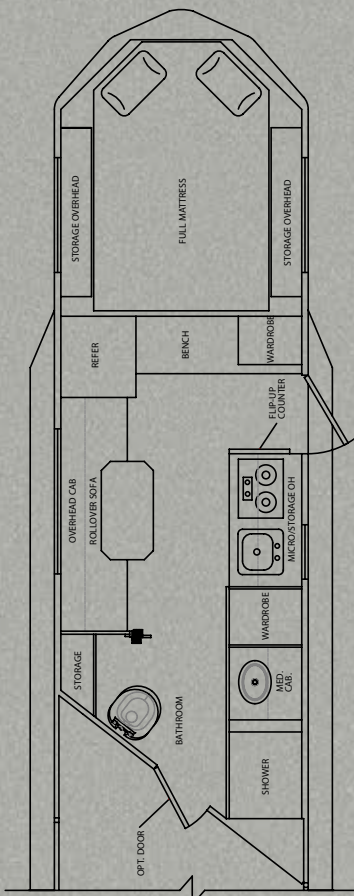

10 X 15

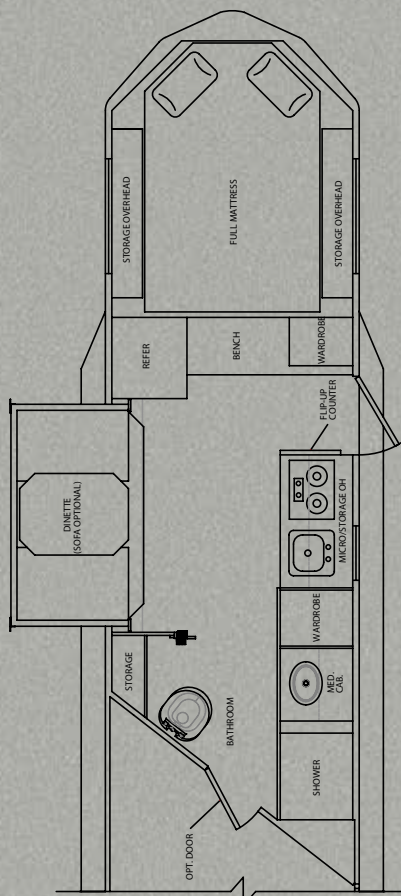

10 X 15 SLIDE-OUT

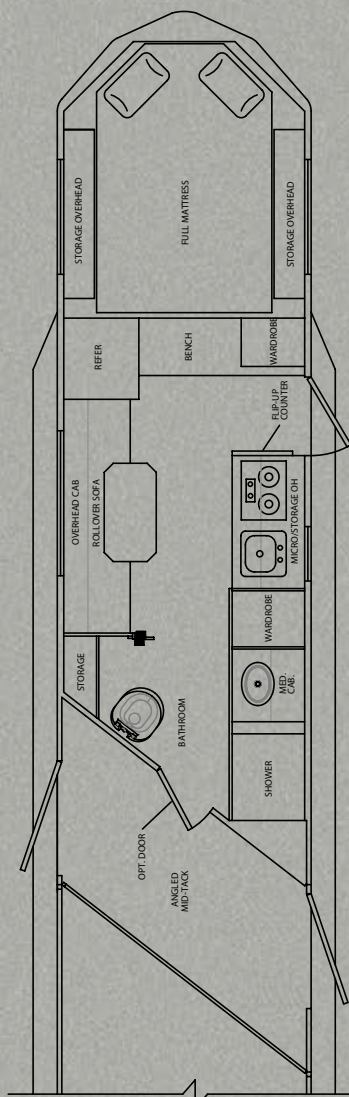

10 X 15 AMT

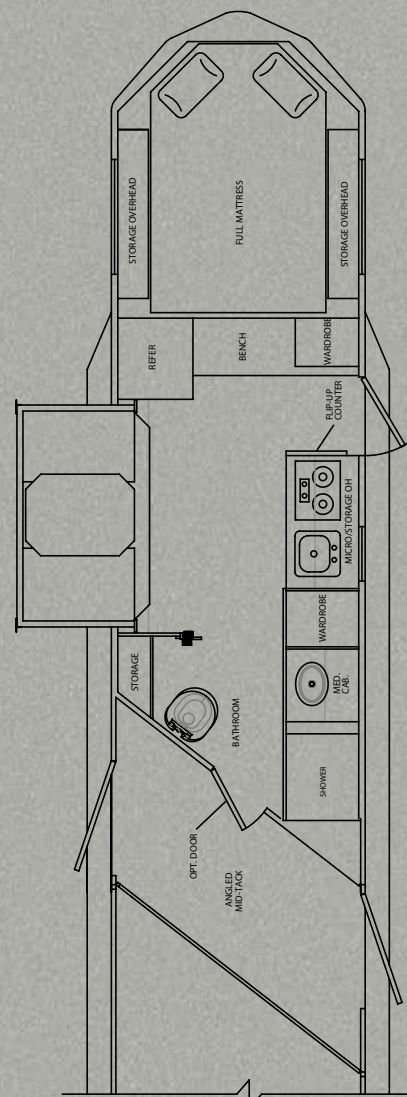

10 X 15 SLIDE OUT
AMT

Standard Interiors



Gooseneck Bed Area



Gooseneck Bed Area

7'0" wide floorplans

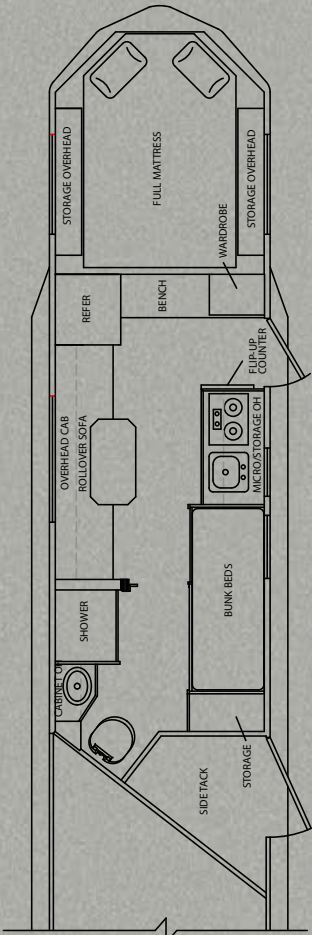

15 X 15

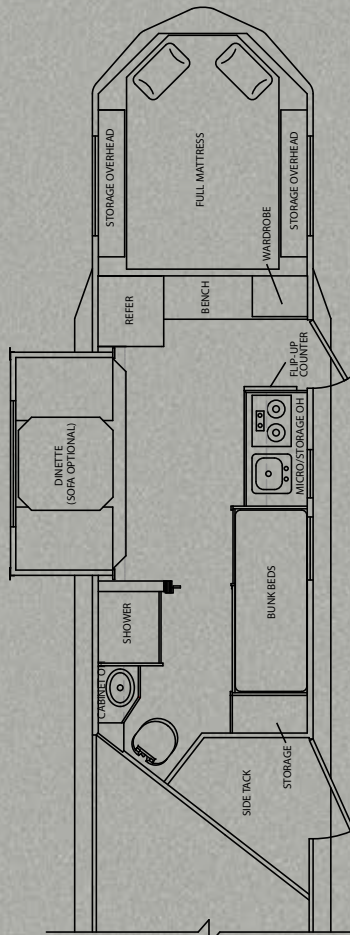

15 x 15 SLIDE-OUT

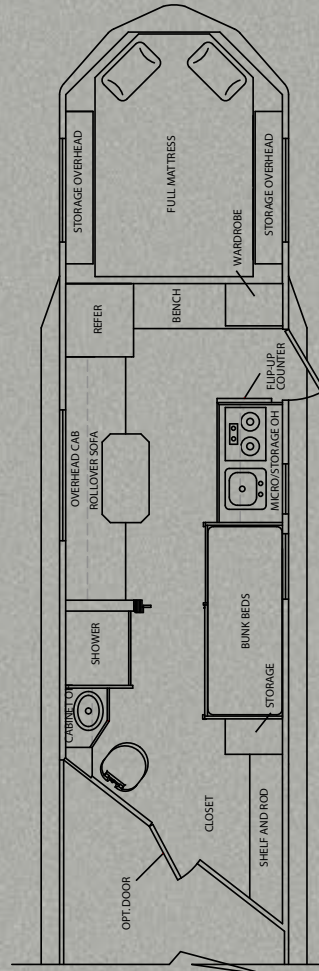

15 X 20

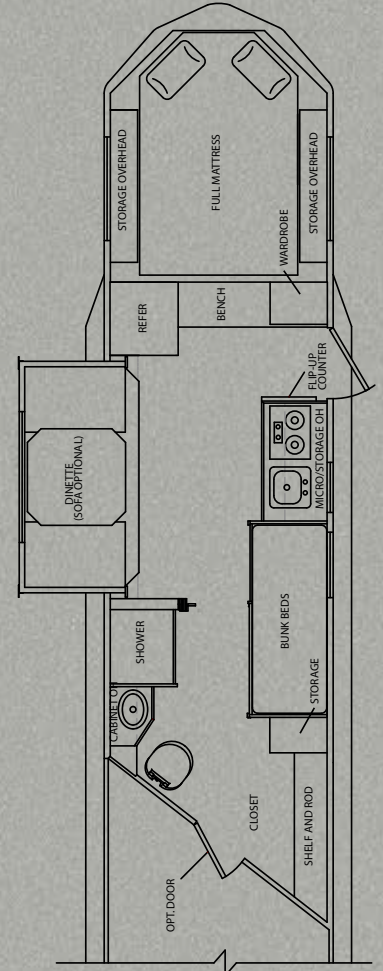

15 X 20 SLIDE-OUT



15 x 20 Galley

Standard Interiors



15 x 20 Slide-out w/ Optional Sofa

accentoptions

Lone Star Accent



Lone Star Valance



Branded Countertop / Table Edge



Coat and Towel Hooks



Running Horse Valance

Running Horse Accent



Coat and Towel Hooks



Branded Countertop / Table Edge

expresspremium

interior packages



Pictured w / Optional Sofa



shellpremium

interior packages



Pictured with optional oven



Pictured w / Optional Sofa



featuresoptions

Models	7'W 5x10	7'W 7x7	7'W 8x13	7'W 10x10	7'W 10x15	7'W 12x12	7'W 15x15	7'W 15x20
CONSTRUCTION & EXTERIOR								
7'0" Wide	S	S	S	S	S	S	S	S
7'6" Tall	S	S	S	S	S	S	S	S
8'0" Gooseneck	S	S	S	S	S	S	S	S
Slide-out	N/A	N/A	O	O	O	O	O	O
Angled Mid Tack	O	N/A	O	N/A	O	N/A	N/A	N/A
Side Tack	N/A	S	N/A	S	N/A	S	S	N/A
Folding Rear Tack	S	O	S	O	S	O	O	S
Sealed Rear Tack	O	O	O	O	O	O	O	O
Stabilizer Jacks @ front end	S	S	S	S	S	S	S	S
Single Speed Crank Jack	S	S	N/A	N/A	N/A	N/A	N/A	N/A
Hydraulic Gooseneck Jack	O	O	S	S	S	S	S	S
Retractable Step @ camper door	S	S	S	S	S	S	S	S
Awning	O	O	O	O	S	S	S	S
Power Awning	O	O	O	O	O	O	O	O
SAFETY								
Fire Extinguisher	S	S	S	S	S	S	S	S
LP Detector	S	S	S	S	S	S	S	S
Smoke Detector	S	S	S	S	S	S	S	S
Carbon Monoxide Detector	S	S	S	S	S	S	S	S
ELECTRICAL								
Pre-Wired for Air Conditioner	S	S	S	S	N/A	N/A	N/A	N/A
Lighted Grab Handle	O	O	O	O	S	S	S	S
Porch Light	S	S	S	S	S	S	S	S
Exterior 110 V Outlet	O	O	O	O	O	O	O	O
Systems Monitor	S	S	S	S	S	S	S	S
30' Electrical Service Cord	S	S	S	S	S	S	S	S
TV Antenna w/Power Booster	O	O	O	O	S	S	S	S
AM/FM Stereo w/CD Player and Speakers	O	O	S	S	S	S	S	S
DVD w/ 10.4" Screen in each Bunk	N/A	N/A	N/A	N/A	N/A	N/A	O	O
21" TV Screen w/DVD Mounted on Swing Arm	O	O	O	O	O	O	O	O
Propane Generator mounted on Front	O	O	O	O	O	O	O	O
Gas Generator mounted in Hay Rack (must have mangers)	O	O	O	O	O	O	O	O
Exterior Speakers	O	O	O	O	O	O	O	O
INTERIOR								
Day / Night Shades w/Valences	S	S	S	S	S	S	S	S
Linoleum Flooring	S	S	S	S	S	S	S	S
Recessed LED Ceiling Lights	S	S	S	S	S	S	S	S
Luan Walls	S	S	S	S	S	S	S	S
Soft Touch Ceiling	S	S	S	S	S	S	S	S
Choice of Lone Star or Running Horse Accessory Package	S	S	S	S	S	S	S	S
Espresso Premium Interior Package	N/A	N/A	O	O	O	O	O	O
Shell Premium Interior Package	N/A	N/A	O	O	O	O	O	O
Synthetic Leather Cushions	N/A	N/A	S	S	S	S	S	S
Walk-in Closet (must have angled mid tack)	O	N/A	O	N/A	O	N/A	N/A	N/A
BATHROOM								
25" X 30" Shower Stall w/ Separate Toilet	N/A	N/A	S	S	S	S	S	S
14" X 14" vent w / Fan	S	S	S	S	S	S	S	S
Shower / Toilet Combo w/ Curtain	S	S	N/A	N/A	N/A	N/A	N/A	N/A
Shower Dome	O	O	O	O	O	O	O	O

*Premium Interior Packages include: Top half of walls — Western Flower tooled fabric, Bottom half of walls — soft touch, padded fabric, LED rope lighting in gooseneck area, galley, and bathroom, Lighted wardrobe cabinets, Exterior LED lighting under awning area, Windows trimmed in stained wood, Mirrors trimmed in stained wood.

featuresoptions

Models	7'W 5x10	7'W 7x7	7'W 8x13	7'W 10x10	7'W 10x15	7'W 12x12	7'W 15x15	7'W 15x20
SLEEPING ACCOMMODATIONS								
Bunk Beds	N/A	N/A	N/A	N/A	N/A	N/A	S	S
California King Mattress	S	S	S	S	S	S	S	S
Bedspring, Pillows & Shams	O	O	S	S	S	S	S	S
Folding Sofa Bed (non-Slide-out)	N/A	N/A	S	S	S	S	S	S
Dinette in Optional Slide Out	N/A	N/A	S	S	S	S	S	S
Sofa in lieu of Dinette in Optional Slide-out	N/A	N/A	O	O	O	O	O	O
GALLEY								
Boot Box w/ Cooler Insert	S	S	N/A	N/A	N/A	N/A	N/A	N/A
3 cubic foot Refrigerator	O	O	S	S	N/A	N/A	N/A	N/A
6 cubic foot Double Door Refrigerator	N/A	N/A	N/A	N/A	S	S	S	S
8 cubic foot Double Door Refrigerator	N/A	N/A	N/A	N/A	O	O	O	O
Flip-Up Counter Top	S	S	S	S	S	S	S	S
2 Burner Cooktop	N/A	N/A	S	S	S	S	S	S
Oven with 3 Burner Cooktop	N/A	N/A	N/A	N/A	O	O	O	O
Exterior Auxiliary Propane Hook-up	O	O	O	O	O	O	O	O
Microwave Oven	O	O	O	O	S	S	S	S
HEATING/INSULATION								
18,000 BTU Forced Air Furnace	O	O	S	S	S	S	S	S
Air Conditioner	O	O	O	O	S	S	S	S
Heat Strip for A/C	O	O	O	O	O	O	O	O
Fantastic Vent	O	O	O	O	O	O	O	O
(2) 5 gal. Auto Changeover LP Tanks	S	S	S	S	S	S	S	S
(2) 7.5 gal. Auto Changeover LP Tanks *	O	O	O	O	O	O	O	O
FRESH & WASTE WATER SYSTEMS								
28 Gallon Fresh Water Tank	S	S	N/A	N/A	N/A	N/A	N/A	N/A
38 Gallon Fresh Water Tank	N/A	N/A	S	S	N/A	N/A	N/A	N/A
48 Gallon Fresh Water Tank	N/A	N/A	N/A	N/A	S	S	S	S
28 Gallon Black Water Holding Tank	S	S	S	S	S	S	S	S
28 Gallon Gray Water Holding Tank	S	S	S	S	S	S	S	S
6 Gallon DSI Water Heater	S	S	S	S	S	S	S	S
Water Heater Bypass	O	O	O	O	O	O	O	O
Exterior Faucet	O	O	O	O	O	O	O	O
* Standard with LP Generator Option								

APPROXIMATE EMPTY WEIGHT								
Size	7Wx5x10	7Wx7x7	7Wx8x13	7Wx10x10	7Wx10x15	7Wx12x12	7Wx15x15	7Wx15x20
2 Horse	7270	7800	8240	9240	9020	9240	10620	10820
3 Horse	7750	8280	9000	9720	9640	9860	11300	11500
4 horse	8290	8820	9900	10260	10260	10480	11920	12120
FLOOR LENGTH								
Size	7Wx5x10	7Wx7x7	7Wx8x13	7Wx10x10	7Wx10x15	7Wx12x12	7Wx15x15	7Wx15x20
2 Horse	17'4"	18'4"	20'0"	21'2"	22'6"	23'4"	26'10"	26'10"
3 Horse	20'9"	21'9"	23'5"	24'7"	25'11"	26'8"	30'2"	30'2"
4 horse	24'2"	25'2"	26'9"	28'0"	29'3"	30'1"	33'7"	33'7"
Note: Angle Mid Tack will add approximately 860# and 5 ft. of length								



WWW.TRAILSWESTTRAILERS.COM



© 2015 Trails West Manufacturing, Inc. All rights reserved. All logos on this brochure are trademarks of Trails West Manufacturing of Idaho, Inc. Specifications are subject to change without notice. Sold exclusively through authorized dealers.

P.O. Box 67 • 65 North 800 West • Preston, Idaho 83263 • (208) 852-2200

