

Murphy Trailer Sales, Inc

3000 Industrial Blvd

Crawfordsville, IN 47933

Bruce Murphy

O: 800-939-7288 C: 765-366-0287

Racehorse4523@yahoo.com

Date:

Deliver Date:

Customer: *BETTY MAZILL*

Address:

717-817-4199

COMMENT, SUGGESTIONS, NOTES & EXTRAS

COST

DESCRIPTION

OPTION

4-STAR HORSE W/ANGLE N. TRACK

Carpet Walls Mid Track

Warm Floor

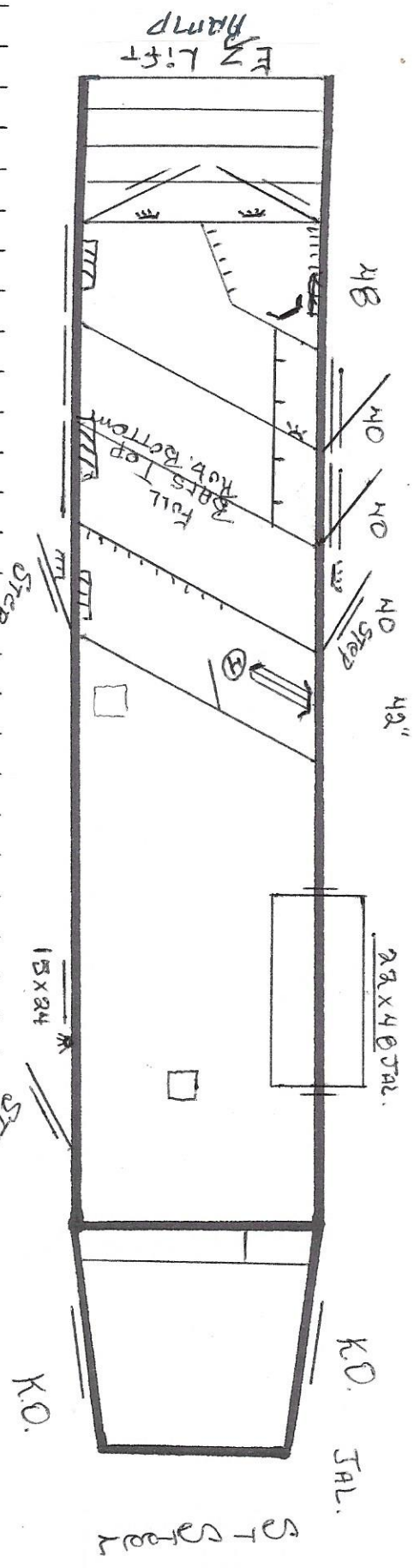

4S3D187	7'x18'x7' Tall 3 Horse Slant Gnk 2-7K Dexter Rubber Torsion,5-10ply	1	\$36,202.00	\$	36,202.00
1250	Axle Torsion 2-8000 w / 5-235/85R16 14ply Tires ilo 5.2K & 7K Axles	1	\$3,537.00	\$	3,537.00
1299	Axle Block Axle 3in,Fender Height Automatically Adjusted	1	\$136.00	\$	136.00
1550	Brakes Electric-Hydraulic Brakes for Tandem Axle Trailers Only	1	\$2,407.00	\$	2,407.00
1600	Carpet Carpet Gooseneck Floor	-1	\$189.00	\$	(189.00)
1603	Carpet Carpet Drop	-1	\$109.00	\$	(109.00)
1606	Carpet Carpet Dressing Room Floor (per sq ft)	-48	\$5.00	\$	(240.00)
1615	Carpet Carpet on Gooseneck Walls (per running ft)	20	\$27.00	\$	540.00
1653	Coupler Shorten Coupler 3" on Gooseneck	1	\$0.00	\$	-
1700	Divider Add 3" Extra Height (Trailers7'6" or Taller)	2	\$134.00	\$	268.00
1710	Divider Full Divider-Bottom Only	1	\$297.00	\$	297.00
1712	Divider Full Divider-Top Only	1	\$297.00	\$	297.00
1724	Divider Spread Air Flow in Divider ilo Standard	2	\$87.00	\$	174.00
1806	Door Large Walk-Thru Door For Tack and Dressing Room	1	\$938.00	\$	938.00
1809	Door Small Bulkhead Door From Horse Compartment to Dressing Room w/ No	1	\$886.00	\$	886.00
1859	Door Access Door (Small Door Only)	2	\$297.00	\$	594.00
2104	Footage Add per 1" to Horse Trailer Dressing Room Length	174	\$65.00	\$	11,310.00
2227	Gooseneck Lower Gooseneck 2"	2	\$138.00	\$	276.00
2235	Gooseneck Enclosed Drop w/Two Access Doors, 96" Neck w/Coupler Forward	1	\$3,552.00	\$	3,552.00
2400	Height Add 6" to Trailer (per ft of box length)	65	\$44.00	\$	2,860.00
2480	Jack Hydraulic Dual Landing Leg Jack. (Battery,Box,Wired Up Included)	1	\$3,444.00	\$	3,444.00
2554	Light LED Dome Light (Each)	-3	\$40.00	\$	(120.00)
2566	Light Oval Surface Mounted Porch Lite (each)	1	\$56.00	\$	56.00
2572	Light LED Additional Marker Light (each)	4	\$28.00	\$	112.00
2578	Light Optonics LED Interior Rectangular Light -1100 Lumens 6"x18"	4	\$94.00	\$	376.00
2591	Light Chrome 11"Awning Load Light LED	4	\$50.00	\$	200.00
2610	Manger 18" Deep Manger (per stall must add manger door)	2	\$504.00	\$	1,008.00
2800	Ramp Spring Loaded Rear Ramp 6',7' & 8' Wide	1	\$1,227.00	\$	1,227.00
2803	Ramp Side or Rear Ramp over 52" Tall - Additional Cost to Ramp Charge	1	\$281.00	\$	281.00
2821	Ramp E-Z Lift Ramp System ilo Std Side or Rear Ramp (Must add for added	1	\$282.00	\$	282.00
2890	Reinforcement Aluminum Angle Reinforcement Hucked to Outside of Bottom	1	\$310.00	\$	310.00
2893	Reinforcement Air Conditioner Brace	1	\$254.00	\$	254.00
2903	Roof Line and Insulate Roof (per inch)	168	\$6.00	\$	1,008.00
2920	Rubber Floor Mats (per square ft)	32	\$7.00	\$	224.00
2922	Rubber WERM Sealed Rubber Floor ilo Std Mats (per square ft,long wall x tri	112	\$14.00	\$	1,568.00
2934	Rubber Rubber (36" tall) Both Sides of Removable or Permanent Full to Floor	1	\$262.00	\$	262.00
2950	Saddle Saddle Racks (each rack)	1	\$106.00	\$	106.00

Option Number and Description Qty Price Total

Distributor Information		Customer Information	
Name	Murphy Trailer Sales, Inc.	Name	
Address	3000 Industrial Blvd.	Address	
City, State, Zip	Crawfordsville, IN 47933	City, State, Zip	
Phone	765-361-8803	Phone	
e-mail		e-mail	
Date		Date	
Quote No.	54	Quote No.	

Bruce 765-366-0287 racehorse4523@yahoo.com \$ 93,676.00

2995	Shelf Propane Compartment in Enclosed Drop	1	\$297.00	\$	297.00
3015	Skin Stainless Steel on Gooseneck Nose	1	\$543.00	\$	543.00
3075	Slide Out 90" Slide Out (36" Deep x 84" Wide x 68" tall inside dimensions)	1	\$9,277.00	\$	9,277.00
3096	Step Fold Down Step	3	\$325.00	\$	975.00
3130	Tack Bridle Hooks (each)	14	\$8.00	\$	112.00
3208	Tire (5) 245/70R17.5 18ply on Steel Wheels ilo (5) 16" 14ply (#6005 Rated	1	\$1,789.00	\$	1,789.00
3260	Vent Brace for Lunar Dome (No Vent)	1	\$138.00	\$	138.00
3300	Wall Bulkhead Wall 6' 7" 8'	1	\$999.00	\$	999.00
3412	Wheel (5) 17.5 Alcoa Aluminum Wheels ilo Steel	1	\$1,769.00	\$	1,769.00
3440	Wheel Well Taper Wheel Well (Ends Only)	.5	\$246.00	\$	123.00
3446	Wheel Well Taper Wheel Wells up to Sides, One Side Only	1	\$188.00	\$	188.00
3460	Width Increase Trailer Width by 1' (per ft of box length)	32.5	\$50.00	\$	1,625.00
3506	Window 15"X24" Window-Jalousie	1	\$353.00	\$	353.00
3516	Window 19"X34" Kick Out Jalousie Window ilo std 15"X34" Window	2	\$295.00	\$	590.00
3522	Window 22"X48" Window-Jalousie	1	\$564.00	\$	564.00

Cash Price

Retail #93,676.00
 5,867.10
 1,200.00
 #14,175.47.00
 Tr. Let
 y.c.
 Rgt

Cash
 7,700.00
 4,170.00
 1,200.00
 #119,500.00
 - 34,500.00
 #85,000.00

Dream Coach

Ext. S.R. setting
 Part End in Bed Here

OK - 8000
 #7,700.00
 HHT 3/10/06 AC - HMK
 #8,000.00

TRAIL BOSS 15FT SHORTWALL SLIDE OUT LEGEND SERIES

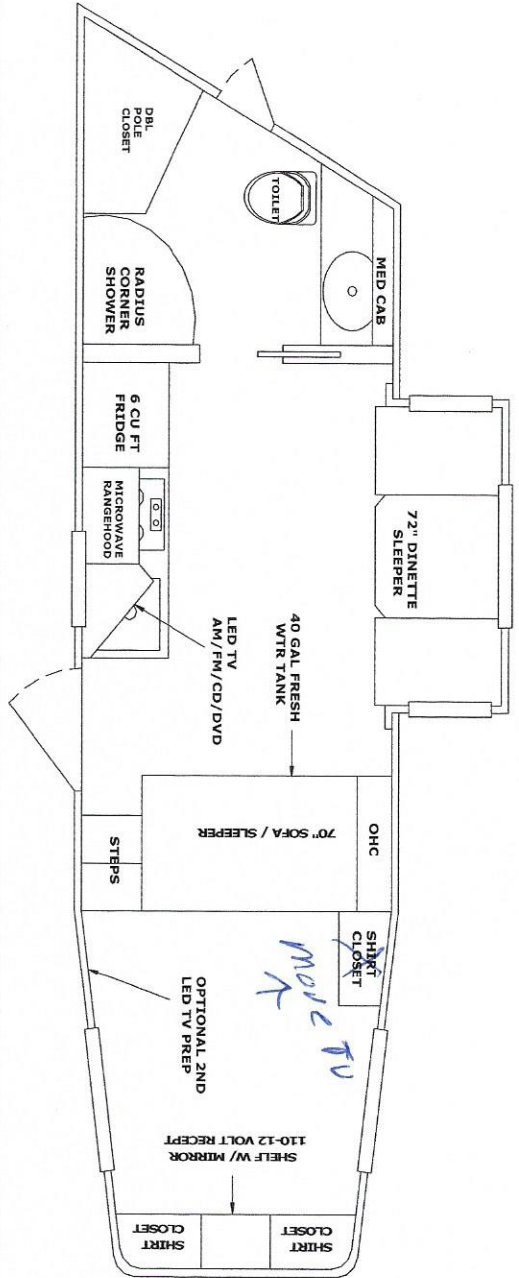

(2017) 15FT "LEGEND SERIES" INTERIOR FEATURES

INTERIOR FEATURES
 13,500 BTU AIR-CONDITIONER
 SOLID OAK OR ALDER CABINETS AND TRIM
 RAISED PANEL CABINET DOORS
 RAISED PANEL CABINET DOORS
 SOFT TOUCH CEILING
 SOFT TOUCH WALLS W/MAJSCOT
 INSULATED CEILING & WALLS
 6 FOOT SLIDE OUT
 SOLID WOOD WINDOW FRAMES
 HOLLOW CORE POCKET DOOR
 WARDROBE STORAGE
 BATHROOM CLOSET
 OVERHEAD CABINETS
 RAISED PANEL REFRIG. DOOR
 RAISED PANEL REFRIG. DOOR
 PLEATED SHADES
 DESIGNER LINDALEUM FLOORS
 CARPETED GOOSENECK FLOOR
 DESIGNER CABINET DOOR KNOBS
 TACKS IN COUNTERTOP WOOD EDGE

APPLIANCES/ELECTRONICS/FURNITURE
 13,500 BTU AIR-CONDITIONER
 DUCTED A/C W/HEAT STRIP
 DIGITAL THERMOSTAT
 COLOR MATCHED A/C SHROUD, VENTS, AND SPEAKERS
 100 LB CAPACITY REFRIG
 6 CU FT REFRIG (110V/LP)
 RANGE VENT HOOD (12V)
 FLUSH MOUNT TWO BURNER LP GAS COOKTOP
 2 INTERIOR SPEAKERS
 2 INTERIOR SPEAKERS
 TV ANTENNA
 LED TV ON SWINGARM IN CABINET
 QUEEN MATTRESS PER LAYOUT
 70" SOFA/SLEEPER
 72" DINETTE SLEEPER W/ TABLE

PLUMBING/LP GAS SYSTEMS
 DOUBLE 20# LP SYSTEM
 12V ON-DEMAND WATER PUMP
 WATER TANK MONITOR
 40 GAL FRESH WATER TANK
 BLACK/GRAY HOLDING TANKS (30 gal. ea)
 6 GAL GAS HOT WATER HEATER (DSI)
 EXTERIOR WATER FAUCET
 PORCELAIN RV TOILET
 RADIUS CORNER SHOWER W/ GLASS DOOR
 SKYLIGHT OVER SHOWER
 FANTASTIC FAN W/ POWER DOME
 LAVATORY SINK
 KITCHEN SINK
 UPGRADE FAUCETS IN KITCHEN AND BATH
 BATHROOM ACCESSORIES
 PAINT MIRROR
 FULL LENGTH MIRROR

ELECTRICAL/LIGHTING/SAFETY
 45 AMP CONVERTOR
 DETACHABLE POWER CORD
 BATTERY DISCONNECT SWITCH
 GFI RECEPTACLES
 EXTERIOR RECEPTACLE
 12V LEADING LIGHTS
 LED LIGHTING PACKAGE
 VANITY BAR LIGHT
 EXTERIOR PORCH LIGHT
 LIGHTED GRAB HANDLE
 TWO STEP AWNING W/ SHIELD
 SLIDE OUT ROOM AWNING W/ SHIELD
 LP GAS DETECTOR
 CO DETECTOR
 SMOKE DETECTOR
 FIRE EXTINGUISHER

QTY	OPTIONAL UPGRADE ITEMS	PRICE	TOTAL
1	SHELVING OPTION (AT MFG DISCRETION)	\$591	\$591
	GOOSENECK PRIVACY WALL W/ POCKET DOOR	\$1,231	\$0
	OHC ALONG PRIVACY WALL ABOVE SOFA	\$723	\$0
1	TIN BACKSPLASH (KITCHEN ONLY)	\$400	\$400
1	UPGRADE TO 15,000 BTU AIR CONDITIONER	\$375	\$375
1	WOODEN COVER FOR A/C CEILING SHROUD	\$341	\$341
2	UPGRADE TO LEATHER YOKE (EA)	\$703	\$1,406
	DESIGNER VALANCE UPGRADE	\$1,262	\$0
1	UPGRADE TO MARBLED RADIUS SHOWER	\$195	\$195
	SINGLE 12V RV BATTERY	\$213	
10	INTERIOR LED STRIP LIGHTS (PER FT)	\$33	\$330
	2ND LED TV PREP IN NOSE	\$138	\$0

QTY	OPTIONAL UPGRADE ITEMS	PRICE	TOTAL
1	2ND LED TV & SWING ARM	\$872	\$872
	DVD PLAYER FOR 2ND LED TV	\$185	\$0
	WINEGARD AUTO SATELLITE W/ RECEIVER (DIRECTV)	\$2,149	\$0
	WINEGARD AUTO SATELLITE W/ RECEIVER (DISH)	\$2,149	\$0
1	UPGRADE TO 9100 SERIES POWER AWNING W/ SHIELD	\$588	\$588
	MULTICOLORED LED STRIP LIGHTS UNDER AWNING	\$528	\$0
	GENERATOR PRE-WIRE PREP W/ TRANSFER SWITCH	\$972	\$0
1	12V RV BATTERY W/ ISOLATOR FOR GENERATOR	\$469	\$469
	4.0 GENERATOR W/ TANK & GAUGE	\$8,095	
1	ROLL UP SCREEN DOOR	\$426	\$426
1	DOUBLE HAT RACK ABOVE DOOR	\$272	\$272
1	ADD DRAWERS UNDER DINETTE BENCH	\$225	\$225

15' SLIDE OUT
 LIVING QUARTERS MSRP=\$46,181.00
 OPTIONAL UPGRADES=6,490.00
 TOTAL MSRP WITH UPGRADES=52,671.00
 SIGNATURE Cash #41,700.00

TRAILER # _____
 COLOR PACKAGE # _____