



"Premier Custom Interiors"
Stephenville, Texas



Dealer: Akins Trailer Sales
Sales Person: Thad
Customer: Salter
Quote Date: 3/8/23
Trailer Mfg: Platinum
Trailer VIN: 12152
Quote Number: 45008.4
Shortwall Length Feet: **14.4**

qrev110121
v21.11

WALLS AND CEILING:	
Wall Covering:	Standard Material (see color sheet)
Ceiling Covering:	Standard Material (see color sheet)
Roof Style:	Standard Roof
CABINETS, DOORS AND WOOD OPTIONS:	
Hardwood Type & Color:	Maple - Ebony Brio
Cabinet Door Style:	Raised Panel
Hardwood Window Box Covers:	Yes - Standard
Nose Cabinets:	Wardrobe
Side Nose Cabinets:	None
Pocket Door(s):	Total of 1
Pocket Door Options:	None
Kitchen Countertop:	Formica with Nail Heads on Edge
Kitchen Backsplash:	See Additional Options
Bath Countertop:	Formica with Nail Heads on Edge
Bath Backsplash:	Formica Standard Height
Flooring:	Vinyl - 88061 Reminiscence Catching Fireflies
Nose Carpet:	Shag - Rice Grain
Headboard Style:	None
Additional Cabinet Options:	3 - Drawers
Additional Cabinet Options:	2nd Step
Additional Cabinet Options:	None
APPLIANCES:	
Refrigerator:	6.0 LP120V
Cooking Appliance:	Microwave Standard
Cooking Appliance:	2-Burner with Flush Glass Cover
HEATING AND COOLING:	
Air Conditioner:	Ducted 15,000 w/Heat Strip & Thermostat
Furnace:	See Additional Options
Additional H/C Options:	Brown A/C Vents and A/C Return Grill
WATER SYSTEMS:	
Water Pump:	Standard 3.2 gpm
Water Heater:	6 Gallon LPG with Electric Start
Fresh Water Tank:	60 Gallon (Requires 72" Sofa)
Waste Holding Tank(s):	1 - Gray & 1 - Black (Standard)
Water Options:	1 -Exterior Water Faucet - Under Nose
Additional Water Options:	1 -Sewer Hose & Carrier
Additional Water Options:	None
Water Monitor System, City Water Fill and Winterizing Kit:	Yes - STANDARD
LPG SYSTEMS:	
LPG System:	Double (2) 30 lb. Tanks

BATH AND GALLEY FIXTURES:	
Vanity:	Vanity, Medicine Cabinet with Mirror
Vanity Light:	Wood Box with 4 Indirect Lights
Vanity Sink & Faucet:	See Next Line for Vanity Sink and Faucet Option:
Standard Almond w/Std Bar Brushed Nickel (SB-BN)	
Toilet:	Porcelain Almond
Shower Style & Color:	32" Radius, Almond
Shower Door Color:	Brushed Nickel - Opaque Glass
Shower Faucet & Head:	Brushed Nickel w/Slider Bar & Levers
Shower Pan Color:	Almond (32", 34", 36" Radius, 32" Neo)
Bath Roof Vent:	Power w/Wall Switch
Nose Roof Vent:	None
Kitchen Roof Vent:	None
Kitchen Sink & Faucet:	See Next Line for Kitchen Sink and Faucet Option:
Standard Almond w/Std Bar Brushed Nickel (SB-BN)	
KNOBBS, MIRRORS AND BATH SETS:	
Total Knobs:	20
Type of Knobs:	Standard Silver
Bath Set:	Standard Silver
Type of Pulls:	NO Pulls
Mirror:	Full Length in Wood Frame with Nail Heads
FURNITURE & BEDDING:	
Seating 1:	Sofa Sleeper 72" - Standard with Rolled Back and Table
Seating 2:	Half Dinette - Standard with Top Roll Back & Table
Seating 3:	NO Furniture
Seating 4:	NO Furniture
Seating 5:	NO Furniture
Bedding:	Outlaw Flex Queen Mattress
Bench Seat - Per Feet:	0
Bench Cushion(s):	No Cushions
Additional Bedding:	None
Additional Bedding:	None
VALANCES, BLINDS, PILLOWS:	
Valance:	Standard
Window Blinds/Shades:	6 - Day and Night
RV Door Window Cover:	1 - Snap Cover (Viny)
Additional Accessories:	None
Additional Accessories:	None
Additional Accessories:	None



"Premier Custom Interiors"
Stephenville, Texas



Dealer: Akins Trailer Sales
Sales Person: Thad
Customer: Salter

Quote Date: 3/8/23

Trailer Mfg: Platinum

Trailer VIN: 12152

Quote Number: 45008.4

qrev110121
v21.11

Shortwall Length Feet: 14.4

GENERATOR and JACKS:

Generator: Onan 4.0 Gas (30-amp) w/ 9 Gallon Fuel Tank & Gauge (if available)

Fuel Tank Location: Rear Tack

Generator Location: Roof (Requires Installed Enclosed Box w/ Vented Door/Panel from MF-G)

Additional Gen. Option: None

Jacks(s): Dual Leg Hydraulic

ADDITIONAL INTERIOR OPTIONS:

Slideout Option: Finish 1 - w/ Standard Front

Additional Options: Folding Screen Door

Additional Options: None

Additional Options: None

Additional Options: None

MID-TACK AND HALF TACK:

Mid-Tack & Half Tack Room Center Line Ft: 0

Finish Out: None

Cabinets: None

Mid-Tack Options: None

SAFETY EQUIPMENT:

Alarms: CO, LP, Smoke Detectors & Fire Extinguisher

Additional Safety: Kick-Out Window(s) Required - Installed at Manufacture

ADDITIONAL OPTIONS:

Kitchen Backsplash Standard Tin to OHC on Back & Side (on angle)

Power Venthood for Cooktop

Ducted Unit 20,000 BTU - 2 ducts

Braelyn Brushed Nickel Wall Lamps

LIGHTING AND ELECTRICAL:	
Power Systems:	120v-30amp w/Power Cord - 90 amp Charger (14' and up)
Additional Power System:	None
120v Outlets:	Standard Brown - Throughout Interior GFI Protected
Additional 120v Options:	1 - Exterior 120v Outlet
12v System:	2- Two Batteries with Aluminum Box (8' to 16')
Ceiling Lights:	Standard LED on Switches
Spot Light:	None
Spot Light:	None
Spot Light:	None
Wall Lamps:	See Additional Options
Wall Lamps:	None
Inside 12v Accessories:	1 - 12v USB Cell Phone Outlet
Inside 12v Accessories:	None
Inside 12v Accessories:	None
Inside 12v Accessories:	None
Exterior 12v Accessories:	1 - Regular Outlaw Grab Handle with Light
Exterior 12v Accessories:	1 - Porch Light (LED)
Exterior 12v Accessories:	None
Exterior 12v Accessories:	None
ELECTRONICS:	
TV Antenna:	Air 360
Exterior Hookup:	None
Stereo:	AM/FM/CD/DVD/MP3/App/Sat Ready (select speakers)
Inside Stereo Speakers:	2 Inside Speakers
Exterior Stereo Speakers:	2 Exterior Speakers
Satellite Radio Options:	None
TV Cabinet:	Pivot Arm
TV Size:	Prewire (1) TV, AV Jack, 120V Outlet
Component:	None
Additional TV Cabinet:	None
Additional TV Size:	None
Additional Component:	None
Automatic Satellite System:	None
Miscellaneous Equipment:	None
AWNING:	
Awning:	Power Awning w/Cover, & LED Lights 17 FT
Additional Awning:	Slide-out Awning w/Cover- Size TBD
Additional Awning:	None
Awning Option:	None

All Customer Furnished Parts Must Arrive Before Production Begins
and any Customer Furnished Parts will not have Outlaw Warranty

Quote Total: \$



Trailer #:

12152

Customer: Salter

Dealer: Akins

WOOD TYPE: MapleWALL COVERING: Ander SlateWOOD STAIN: Ebony BrioCEILING COVERING: Allison Sandstone

PAINT COLOR: _____

FURNITURE: SofaCOVERING: Illusion Charcoal with Milano Platinum Stone Top RollFURNITURE: Half DinetteCOVERING: Illusion Charcoal with Milano Platinum Stone Top Roll

FURNITURE: _____

COVERING: _____

WINDOW COVER FOR RV DOOR: _____

Snap Cover - Ander SlateDAY/NIGHT SHADES: DAY: White

Gray Frame

NIGHT: Dark Gray

OTHER SHADES (if applicable) daytime, mini, blackout etc.: _____

VALANCES: Maple Ebony Brio Standard Scallop with BS Nail Heads

PILLOW(S): _____

COMFORTER: _____

KITCHEN COUNTERTOP: _____

1885K-07 Marmo Bianco with BS Nail Heads

KITCHEN BACKSPLASH: _____

Standard Silver Tin to OHC on Back & Side (on angle)

BATH COUNTERTOP: _____

1885K-07 Marmo Bianco with BS Nail Heads

BATH BACKSPLASH: _____

Standard FormicaNOSE CARPET: Rice GrainFLOORING: 88061 Reminisce Catching Fireflies

Special Instructions/Comments:

OUTLAW DÉCOR: _____

Standard Slide Out Front

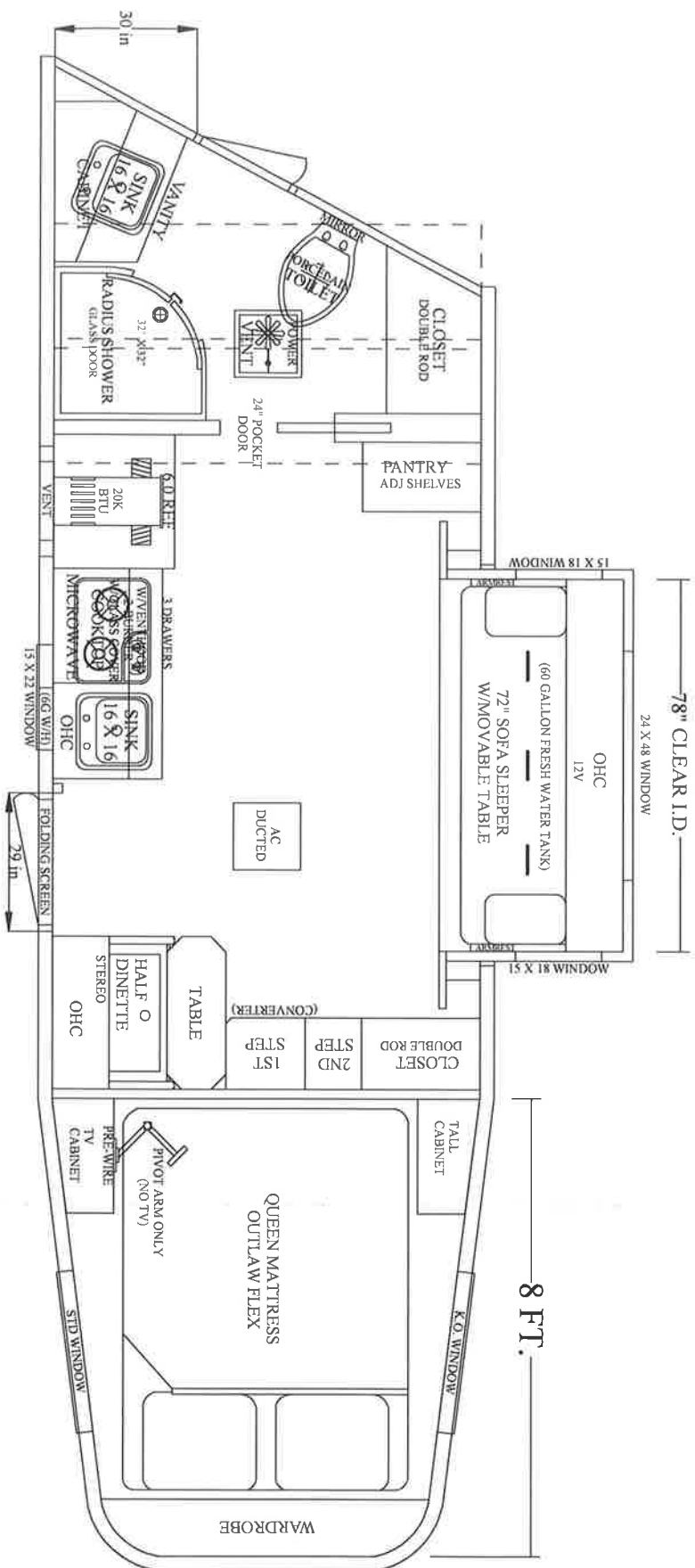

SHORT WALL	
14 FT. 4 IN.	
WIDTH	HEIGHT
8 FT.	7 FT. 6 IN.

OUTLAW CONVERSIONS			
1000 AIRPORT ROAD, STEPHENVILLE, TX 76401			
DEALER	MANUFACTURER	DATE	VERSION
AKINS	PLATINUM	06-JAN-23	12152
CUSTOMER	DATE	DESIGN BY	EXT. NO.
SALTER		JC	03