



DAY TRIPPER

BY OUTBACK CUSTOMS

12.8 Day Tripper Series Quote sheet

Date: 5/17/2021 Trailer #: 20924 P3 Dealer: DELWOOD Customer: INVENTORY Decor Option: _____

2021 Standard Features

Cabinets & Trim

- Solid Alder trim and cabinets throughout
- Oversized Crown molding throughout
- Solid wood Raised Panel cabinet doors
- Prep for sliding screen on entry door
- High definition laminate countertops with wood edges
- Side cabinets with center console in front bunk
- Shelves & drawers in base cabinets when possible
- Overhead cabinet above kitchen and sofa
- Wardrobe closet in bathroom

Appliances and Electronics

- 13,500BTU Ducted Air conditioner with heat strip & thermostat
- 20,000BTU Ducted LP forced air furnace
- Built-in Convection Microwave
- Recessed 2 burner cook top and vented range hood
- 6 Cu.Ft. 120volt/LP refrigerator with door insert
- AM/FM/CD/DVD Stereo with 2 inside and 2 outside speakers
- 24" TV tied to stereo DVD player at main location with prep in bunk

Liability and Construction

- Commercial grade vinyl flooring with carpet in bunk area
- Mirrored solid wood pocket door into bath
- Wood Lower walls to match cabinets
- Leather touch walls and ceiling throughout
- Insulated walls and ceiling
- Insulated Main LQ & Bunk floor
- Deluxe style seating with premium leather touch
- Pleated Shades on all windows (Snap cover on entry door window)
- Upgraded Queen memory foam mattress
- Smoke, CO2, and LP detector with fire extinguisher
- Sky dome above shower with solid wood trim ring
- Third party inspected and Certified
- Two year no hassle full coverage warranty

Electrical Features

- Generator Pre-wire with transfer switch, remote start & gas gauge
- LED recessed ceiling lights throughout
- LED Lighted grab handle
- LED Exterior 12 volt porch light
- Exterior Hook up light under gooseneck area
- Vanity light at bathroom medicine cabinet
- GFCI protected 120volt Receptacles in bath, kitchen, and outside
- 12 and 120volt receptacle at gooseneck front center console
- 30amp Shore cord inlet and 30' shore cord
- 55 amp 120/120volt power converter
- Batteries installed by trailer manufacturer
- Coach monitoring system
- 30amp Main breaker and fuse panel
- 12volt power lift bath fan

Plumbing Features

- 12volt on demand water pump with antifreeze injector
- 6 Gallon LP water heater with electronic ignition
- Porcelain toilet
- Stainless steel kitchen and bath sink
- Sewer hose & holder under gooseneck
- 42 Gallon fresh water tank minimum
- 33 Gallon black and grey waste tanks
- 32" Neo Radius Shower with glass shower door
- Brushed Nickel colored faucets
- Outside water spigot under gooseneck
- Dual 20# LPG Tanks with auto change regulator

Décor Features

- Brushed nickel colored hardware throughout
- Leather touch wrapped window valances to match seating
- Leather touch door panels on entry and pass through door

Base package pricing

1	Floor Plan 12.8-1 Base Price	\$46,183.00	Floor Plan 12.8-2 Base Price	\$46,183.00
	Floor Plan 12.8-3 Base Price	\$47,592.00	Floor Plan 12.8-4 Base Price	\$46,836.00

Available Options

	3.6 LP Generator mounted on roof with 30# tanks	\$8,462.00	1	Upgrade to Day-Night Shades	\$448.00
	4.0 Gas generator mounted on roof with gas gauge	\$8,462.00		2 Solid wood hat racks mounted above entry door	\$425.00
	Self seeking satellite dish with DirecTV receiver	\$2,358.00		Solid wood AC & Fan cover	\$566.00
	Self seeking satellite dish for Dish network receiver	\$2,358.00	1	12'-19' Electric awning with metal cover	\$2,323.00
	Additional satellite receiver for 2nd TV location	\$538.00		Full Color LED Light strip below awning	\$406.00
	Additional 24" LED TV in bunk tied to stereo DVD player	\$1,049.00		Faux Tin tile back splash in kitchen and bathroom	\$913.00
1	Roll up screen for entry door	\$478.00		Black exterior hardware and vents	N/C
	Oil Rubbed hardware with almond sinks & black appliances	\$890.00		Dinette-sleeper in place of sofa-sleeper (12.8-2 & 4 Only)	N/C
	Overhead flip-down bunk above sofa	\$2,469.00			
Grand total including all selected options					\$49,432.00

Day Tripper 12.8 Floor Plans

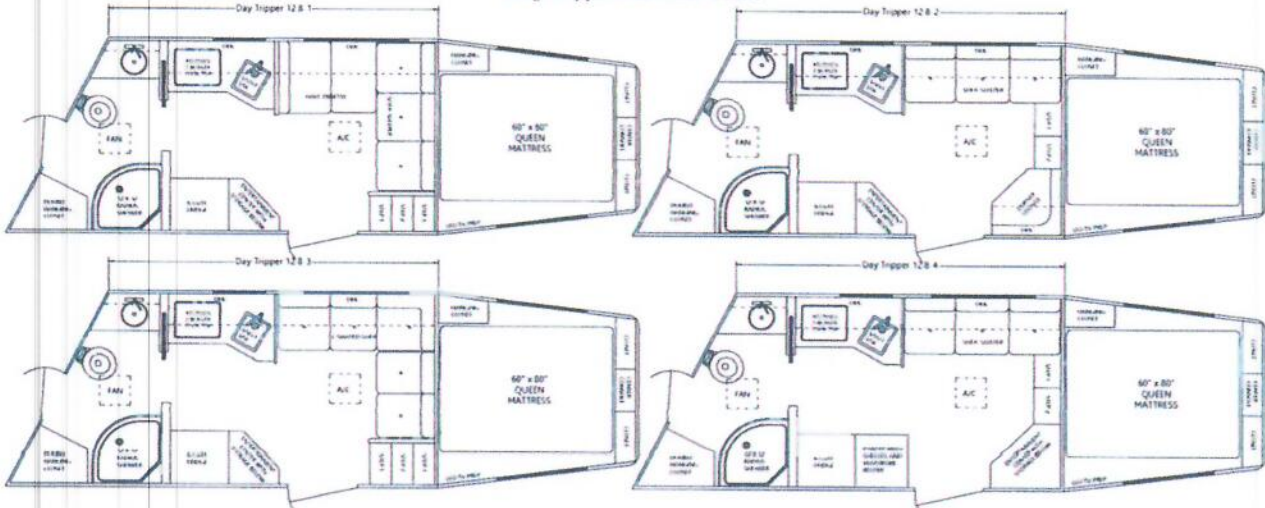

Special Notes: UPDATED TO NEW PRICE SHEET 2/10/22



Trailer Order

1 Medium

Job Number 20924 Rev: D P3

Dealer: Delwood

Customer: INVENTORY

Model: 4H 12' 8" MUSTANG LQ

W L H
8 x 30 x 7.5

Standard Features

Category	Option#	Description	Qty
BASE TRL	412MLQ	Elite 8' X 30' X 7'6" Four Horse Gooseneck -- 12' 8" Mustang LQ	1
COUPLER	2106	Coupler -- Std 2-5/16" Adj (20,000#)	1
COUPLER	2111	Coupler -- Safety Chains & Break-Away Kit	1
JACK	4103MS	Jack -- 12K Hydraulic Single Leg Jack w/ Cover	1
BATTERY	1503M	Battery -- Dual Battery Box Wired Up w/ 2- Batteries	1
AXLE	1220M	Axle -- Block Axles 2" & Lower Fenders	1
AXLE	1223A	Axle -- Two -- Std 8,000# Axles	1
AXLE	1224	Axle -- Std Rubber Torsion	1
BRAKES	1755	Brakes -- Std Electric Brakes	1
TIRE	8426	Tire -- (5) Std LT235/85R16 Load Range "G" Wheels & Tires - Rated 3,750# Each	1
WHEEL	9500	SEE OPTIONS	1
WHEEL	9511	Wheel -- Std Spare Tire Carrier	1
FLOOR	3102	Floor -- Std .125 Smooth Alum (5052 Marine Grade)	1
E SKIN	2910	Exterior Skin -- Std White Alum Skin Above Slats (.050 -h291 Temp)	1
NOSE	5202M	Nose -- Std SSTL On Nose	1
NOSE	5203	Nose -- 8' Long Nose	1
NOSE	5212	Nose -- Std 2' Taper	1
DROP HT	5204M	Nose -- Drop Height 44-1/2"	1
WINDOW	9921M	Window -- Std -- (1) - 19" X 34" Window & (1) - 19" X 34" Kick Out Window In Nose	1
DRP DOOR	2603M	Door -- Drop Down Door w/ Window C/S w/ Latch Placed at Bottom	4
DRP DOOR	2603S	Door -- Drop Down Door w/ Window at Head Side w/ Latch Placed at Bottom (Escape Door Not Included)	3
ESCAPE	2620M	Door -- Std Escape Door w/ Drop Down Window at 1st Horse (w/ Latch Placed at Bottom)	1
DP/BARS	1406P	Bars -- "Production Style" Drop Down Window Bars. (1- Per Horse)	4
REAR DR	2633M	Door -- Std Double Rear Doors w/ Windows - (56/44)	1
D/R DOOR	2609M	Door -- Retrofit -- Dressing Room 29-1/8" Opening	1
DIVIDER	2409M	Divider -- Std Manger Style Dividers w/Padding	3
MANGER	5003M3	Manger -- Manger Pkg (3 - 18" Deep Mangers - 48" To Top Of Lip Above Rubber - 4-3/4" Deep Pan, 2 Access Doors, 1 Dome Light)	1
LIGHT	4400M	Light -- Std Running Lights 3- Each Side	1

LIGHT	4402	Light -- 7-way Plug & Wiring	1
LIGHT	4406B	Light -- Std 3 Dome Lights w/ Enclosed Wire Harness System	1
LIGHT	4407GM	Light -- LED "Awning Style" Load Light - Chrome Plastic Housing (2" x 18") (700 Lumens)	1
LIGHT	4408A	Light -- All Interior Lights (390 Lumens) & Exterior Marker Lights Are LED	1
IN TIES	8305S	Tie -- Std Trailer Ties (Inside) 2-per Horse	8
OUT TIES	8306M	Tie -- 4 Std Trailer Ties (Outside) (2 Each Side)	4
VENT	8708S	Vent -- Std Two Way Roof Vents (1-per Horse)	4
BARS	1402S	SEE OPTIONS	1
BARS	1407	Bars -- Std Breast/Butt Bars At All Horse Area Doors.	1
S.RACK	7207	Saddle Rack -- Std Saddle Racks (1-per Horse)	4
HOOKS	3901	Hooks -- Std Bridle Hooks, 10	10
TRAYS	8501	Trays -- Std Brush Tray, One (1),	1
MAT	5100S	Mat -- Std Rubber Floor Mats In Horse Area	1
RUBBER	6907S	Rubber -- Smooth Rubber Head & Rump Wall, Blkhd Wall & Wheel Wells	1
WALL-LIN	9005S	Wall -- Double Wall & Insulate Horse Area (Head & Rump Walls)	1
WALL-BH	9001S	Wall - Std Bulkhead Wall	1
WALL-BH	9018S	Wall - Padding On Bulkhead Wall & Rear Tack Wall	1
W/T	2600M	Door -- Walk Thru Door In Bulkhead	1
RTACK	9003M	Wall -- Collapsible Rear Tack Wall w/ Removable Center Post & Removable Post For Saddle Rack	1
STEP	7703ES	Step -- Fold Up Step (12" Tall Extruded)	1
TAPE	8211S	Tape & Striping - D.O.T. Reflective Tape	1
BUMPER	1850	Bumper -- 4" Rubber Dock Bumper	1
LQ WINDO	9900M	Window -- 15" X 24" Window (Sliding)	1
LQ WINDO	9931M	Window -- 22" X 48" Window (Sliding)	1
BRACE	1728MS	Brace -- L.Q. Pkg (Bracing For Holding Tanks, L/P, A/C, & Shower Dome)	1

Base Price: **\$74,825**

Additions / Deletions

Category	Option#	Description	Qty	Price
WHEEL	9512A	Wheel -- Aluminum Wheel ILO Std (Gray Inset) 16" Wheel Only (Each)	5	\$780
LATCH	4201	Latch -- Add Camper Latch	1	\$216
	NOTE:	ESCAPE DOOR		
DIVIDER	2408	Divider -- Removable Lower Panel On Divider	1	\$604
BARS	1402	Bars -- Additional Blanket Bar (Each)	3	\$303
BARS	1405	Bars -- Make Blanket Bar Rack Swing Out	1	\$142
	NOTE:	MAKES 4 ON SWING OUT IN RT		
STEP	7703E	Step -- Fold Up Step (12" Tall Extruded)	1	\$270
	NOTE:	ESCAPE DOOR		

MISC	5161	Misc -- Material Surcharge	1	\$11,019
	NOTE:	P3 - MAY SURCHARGE RATE – 14% BASE & OPTIONS		
INTERIOR	20019	Interior -- Custom Interior Package	1	\$49,432
	NOTE:	P3 - OUTBACK DAY TRIPPER UPDATE PRICING		
INTERIOR	20025	Interior -- 12' 8" Mustang Floor Plan # 1	1	\$0
HAY RACK	3700A	Hay Rack -- 6' Aerodyne Hayrack w/ Ladder & Tie Rail	1	\$1,567
NOTE	NOTE	P2 - UPDATED PRICE AS OF 6-25-21		
NOTE	NOTE	P1 - UPDATED PRICING		

Options Total: **\$64,333**

Total Price: **\$139,158**

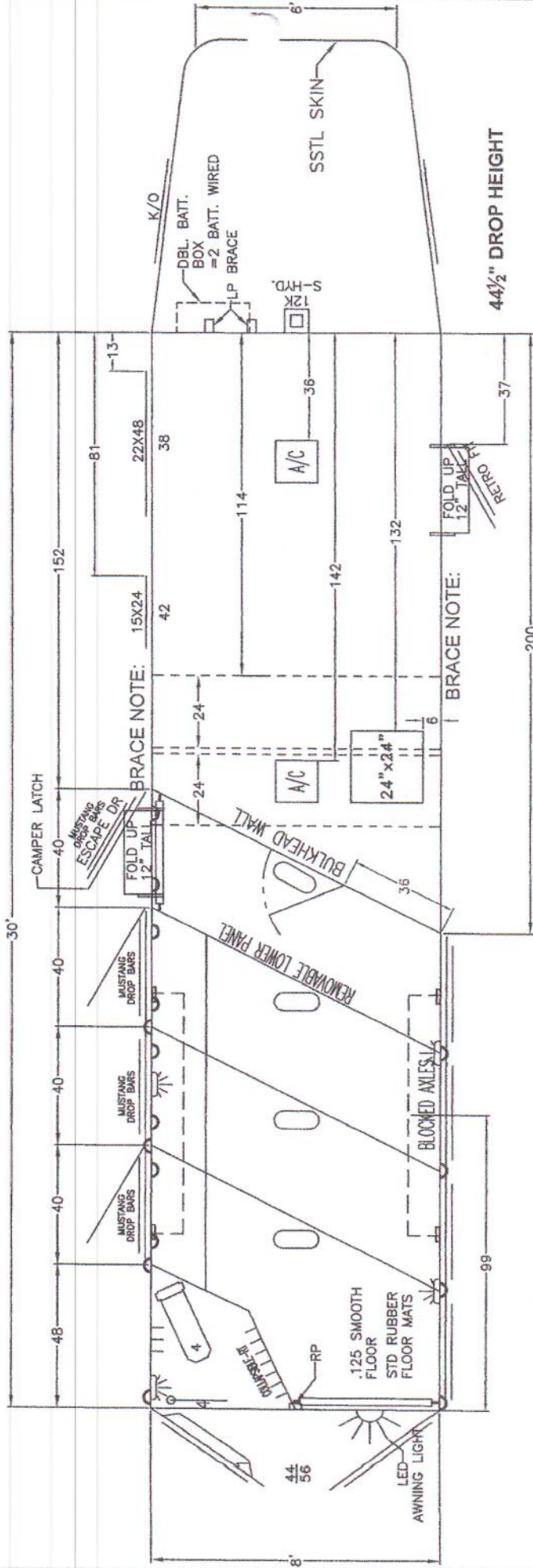

WHITE SKIN ABOVE SLATS
 STD. RUBBER HEAD & RUMP WALL, BLKHD WALL & WHEEL WELLS
 3 LIGHTS EACH SIDE
 6' AERODYNE HAY RACK W/LADDER & TIE RAIL

BRACE NOTE:

- C/S 22" (W) x 14" (T) FRIDGE BRACE, START @ 98 1/2" B.O.D., 21" OFF FLOOR.
- S/S 13" (W) x 13" (T) HOT WATER BRACE, START @ 81" B.O.D., 6" OFF FLOOR.
- C/S 18 1/2" (W) x 8 1/2" (T) FURNACE BRACE, START @ 100 1/2" B.O.D., 6" OFF FLOOR.

BRACE NOTE:

- FOLD UP 12" JACK
- RETRO LIGHT

"ALL DIMENSIONS ARE APPROXIMATE ONLY"
 "STALLS ARE DIMENSIONED FROM CENTER LINE TO CENTER LINE"

OK TO BUILD:

TRAILER WEIGHT INFORMATION

FOR SPECIFIC WEIGHT CAPACITIES AND CALCULATIONS SEE THE TRAILER WORKSHEET CREATED FOR THIS TRAILER. !!!ASK YOUR DEALER FOR A COPY!!!
 ATTN: LQ MFR IF THESE VALUES ARE INCORRECT FOR THIS APPLICATION CONTACT ELITE TRAILERS SO THAT WE CAN CORRECTLY ESTIMATE THE GWR ON THIS TRAILER!!!

This drawing and/or information containing this drawing is the sole property of Elite Trailer Manufacturing L.L.C. and is loaned with the expressed condition that it is not to be used in any way, deleterious to the interest of Elite Trailer Manufacturing L.L.C. The acceptance of this drawing and/or information containing this drawing will be construed as an acceptance of the foregoing conditions. Drawing and/or information containing this drawing are to be returned to Elite Trailer Manufacturing L.L.C. upon request.

REV:	BY:	DATE:	A/C BRACE	BRIDAL HOOKS	BRUSH TRAY	DOME/PORCH LIGHT	LOAD LIGHT	LUNER DOME VENT	JACK LEG	WELDED TIE RING	BOLT-ON TIE RING	BULKHEAD DOOR	BUTT/ BREAST BAR	STEP	FEED BAG	BATTERY BOX	LP BRACE
1	TN	5/17/21															
			WIDTH			8'			DRAWN BY:			TN					
			LENGTH			30'			DATE:			5/10/21					
			HEIGHT			7'6"			JOB#			20924					